

Part Number	Size (Male)	A	B	C	D
30-310-0	9-pin	16.92	25.00	30.80	19.2
30-311-0	15-pin	25.25	33.30	39.20	27.7
30-312-0	25-pin	38.96	47.10	53.10	41.1
30-313-0	37-pin	55.42	63.50	69.40	57.3

Part Number	Size (Female)	A	B	C	D
30-320-0	9-pin	16.30	25.00	30.80	19.2
30-321-0	15-pin	24.60	33.30	39.20	27.7
30-322-0	25-pin	38.30	47.10	53.10	41.1
30-323-0	37-pin	55.42	63.50	69.40	57.3

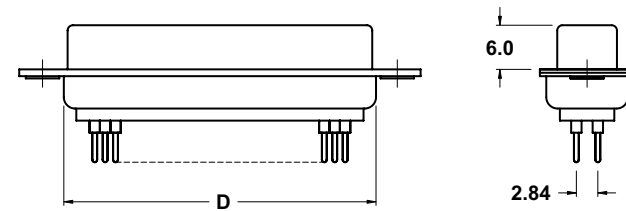
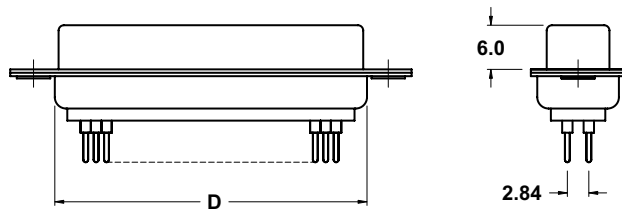
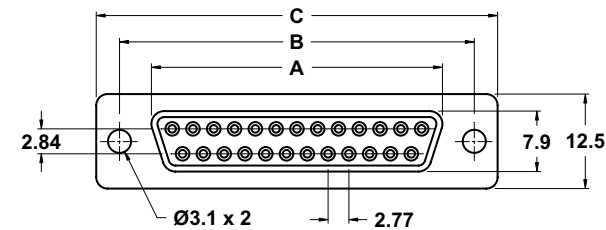
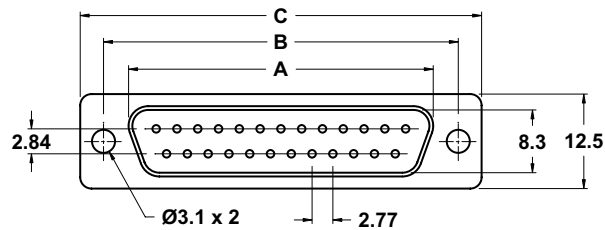

MALE

FEMALE

NOTE:

Electrical

Current Rating: 3 Amps
 Contact Resistance: < 15 Milliohms
 Insulation Resistance: > 3000 Megaohms
 Dielectric: 1000V @ 1 Minute
 Operating Temp.: -55°C to 105°C

Materials

Insulator: PBT Glass Filled UL 94V-0
 Contacts: Brass or Phosphor Bronze
 Shell: Steel
 Contact Plating: Gold Flash
 Shell Plating: Tin over Copper plating

TITLE		SCALE
PRINTED CIRCUIT MOUNT D-SUB		1 : 1
DRAWING NO.	30-31X & 30-32X	
	UNITS	mm
FILE NAME	30-31X & 30-32X.pdf	
	SHEET	1/1



Mode Electronics Part Number 'multi-parts'